



MF-1-200

SETTING SHEET

VER-1.0

Driver:	Airtemp:	Size:	<input type="checkbox"/> Open	<input type="checkbox"/> Med.	<input type="checkbox"/> Tight
Date:	Humidity:	Traction:	<input type="checkbox"/> High	<input type="checkbox"/> Med.	<input type="checkbox"/> Low
Track:	Track temp:	Surface:	<input type="checkbox"/> Smooth	<input type="checkbox"/> Med.	<input type="checkbox"/> Bumpy

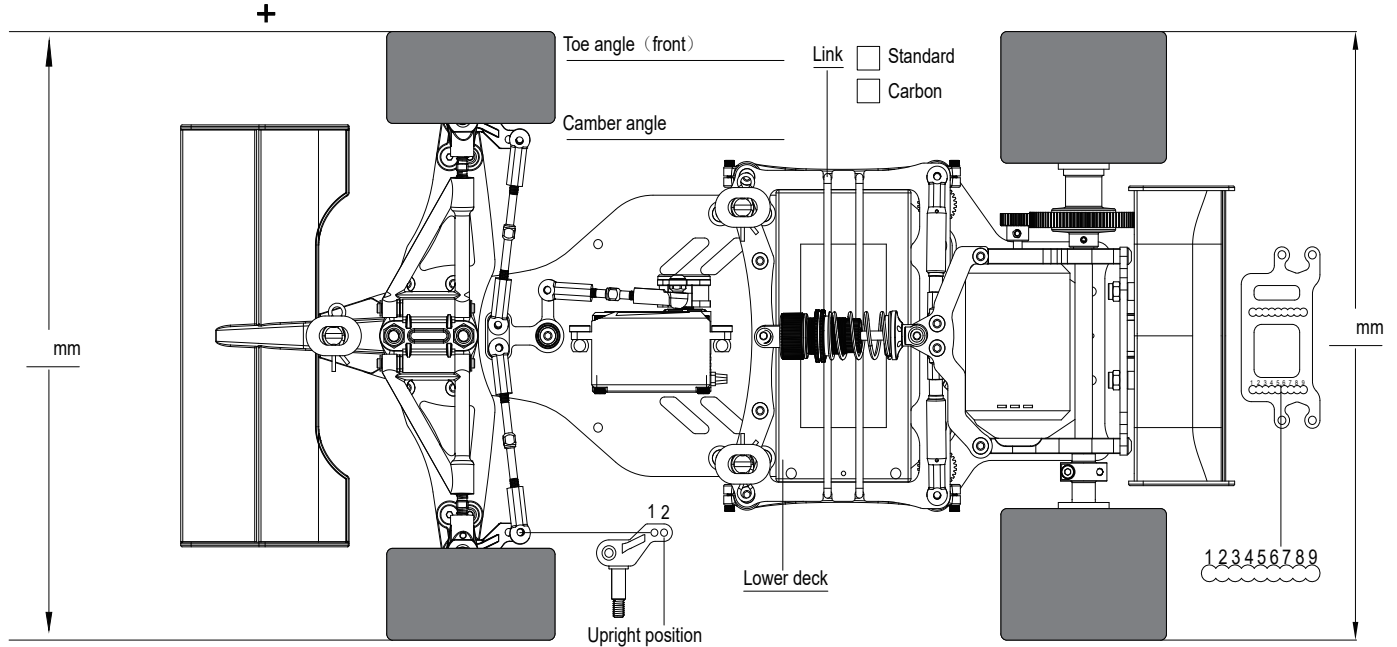

《Front》

- ☐ 1.0mm
☐ 2.0mm

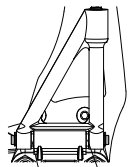
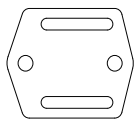

Front Spacer Rear Spacer

- ☐ x2 — 3°
☐ x1 x1 6°
☐ — x2 9°

- ☐ Soft(gold)
☐ Medium(silver)
☐ Hard(black)

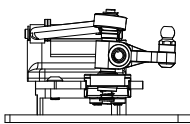

Upright spacer mm
Rebound stroke mm

《Rear》

- Spacer mm
☐ 0mm
☐ 1.0mm
- Rear wing
☐ Standard
☐ Carbon
- Spacer mm
☐ 7.3mm
☐ 10mm

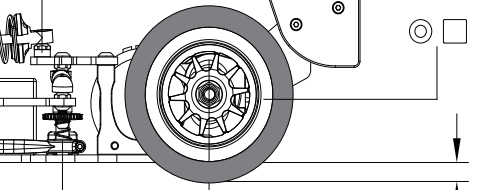

- ☐ Soft(gold)
☐ Medium(silver)
☐ Hard(black)

Roll spring mm

Hole Position

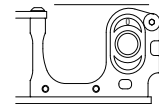

Ground clearance mm

- ☐ Top
☐ Bottom

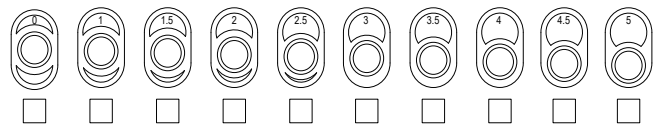

《Damper》

Coil spring Roll damper

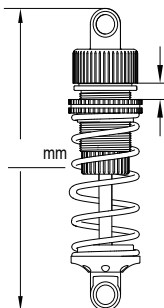

mm
Piston hole(S)
Oil #

- ☐ Soft(gold)
☐ Medium(silver)
☐ Hard(black)



Oil #

Motor	Spur gear	T	Pinion gear	T
Front wheel	Front tire		Front tire diameter	mm
Rear wheel	Rear tire		Rear tire diameter	mm
Body	Front wing		Rear wing	
Battery	Best lap			
Memo				